

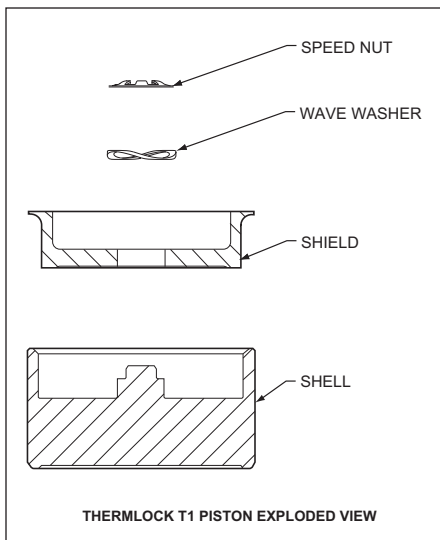

# Thermlock® Piston Technology

Wilwood's exclusive **Thermlock®** Pistons provide the most effective thermal barrier available for minimizing heat transfer from the brake pads to the caliper body, seals, and fluid. This innovative multi-part design incorporates a stainless steel shield and coated aluminum shell configuration that effectively retards heat transfer by 25% and more. Lower operating temperatures translate to the elimination of seal crystallization, the elimination of localized fluid boiling, and longer service life through decreased distortion in the caliper body and piston bores. This technology was originally developed for the extreme temperatures and sustained high heat realized in NASCAR and professional category road racing. The applications now cover all the popular Wilwood calipers used for extreme duty short track and road course competition.

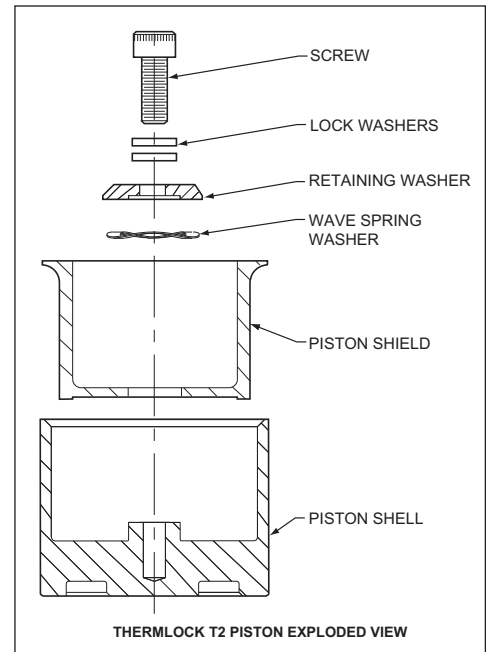

**Thermlock® T2** pistons are the latest design deep cup pistons used as standard equipment in the STR, Prolite, Integra, and GTIII/ST calipers. The T2 series utilizes increased shield wall thickness and a revised thermal barrier configuration to eliminate

all compressibility within the piston. The part numbers listed below can be used as current service replacements or as upgrades for older model calipers.

**Thermlock® T1** pistons are the latest intermediate and short length designs used as standard equipment in all W6AR, W4AR, Superlite, and GN III caliper models that include the "ST" model designation. The T1 pistons feature a revised shield, shell, and thermal barrier configuration to eliminate all compressibility within the piston. The part numbers listed below can be used as current service replacements, or as upgrades in any stainless steel piston equipped or older model calipers.

<u>T2 PART NO.</u>	<u>DIAMETER</u>	<u>LENGTH</u>	<u>CALIPER APPLICATIONS</u>
200-7398	1.62"	1.40"	STR, Integra 4 and 6, Prolite 4 and 6
200-7402	1.25"	1.40"	STR, Integra 6R, Prolite 6R

<u>T1 PART NO.</u>	<u>DIAMETER</u>	<u>LENGTH</u>	<u>CALIPER APPLICATIONS</u>
200-7550	1.88"	1.05"	W6AR, W4AR, Superlite
200-7551	1.75"	1.05"	W6AR, W4AR, SL, NDL, NDP, GN III
200-7552	1.75"	0.88"	TC6R, Dynalite, DynaPro
200-7553	1.62"	1.05"	W6AR, W4AR, Superlite, NDL, NDP
200-7554	1.38"	1.05"	W6AR, W4AR, SL, NDL, NDP, GN III
200-7555	1.25"	1.05"	W6AR, W4AR, Superlite, IR-GT
200-7556	1.12"	1.05"	W6AR, W4AR, Superlite, IR-GT, NDL, NDP
200-7557	1.00"	1.05"	Superlite, IR-GT, NDL, NDP
200-9615	1.62"	0.88"	TC6R, BNSL6R, Dynalite, DynaPro
200-9616	1.38"	0.88"	TC6R, Dynalite, DynaPro
200-11342	1.12"	0.88"	TC6R, BNSL6R, Dynalite, DynaPro
200-11343	1.25"	0.88"	TC6R, Dynalite, DynaPro